

Showers & Washroom Solutions

Public. Commercial. Hotels



CNX Water Management-System

Innovative and reliable

CNX Water Management-System presents the most advanced level in new electronic modular product ranges. In addition to the proven CONTI+ shower faucets, it can integrate our electronic washbasin faucets and urinals.

With the CNX Controller, up to 150 faucets or other devices can be managed from a central point.

Thanks to the integrated web server, using a PC, tablet or smartphone, we can adjust settings, call up status information, activate devices and functions and look up recorded data wirelessly.

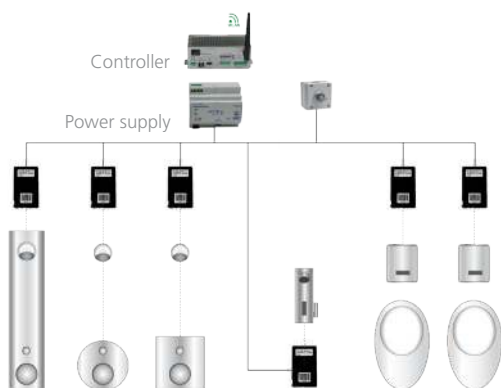
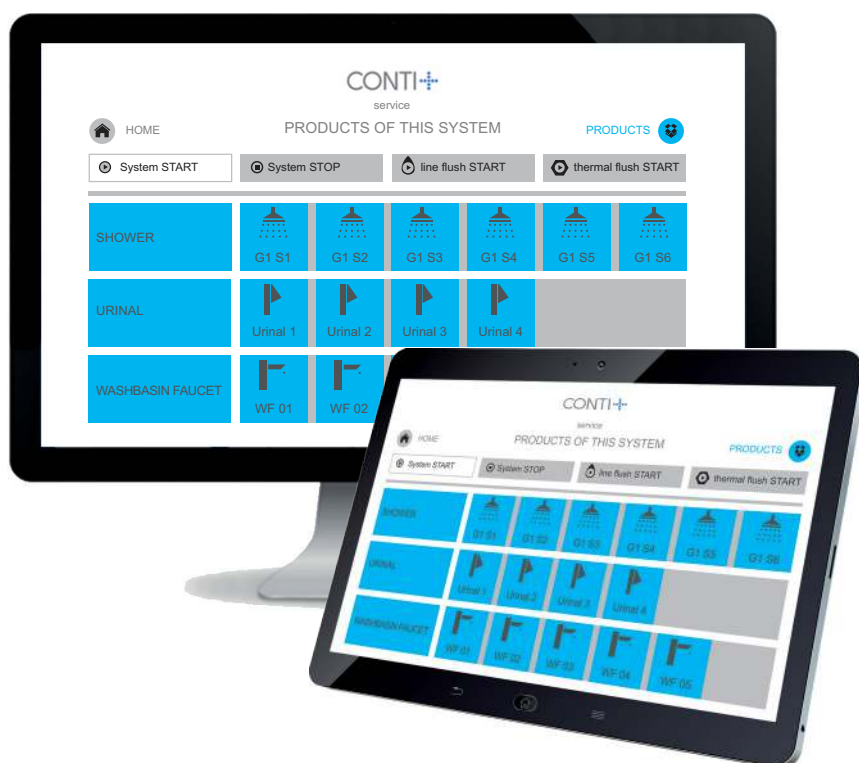

Innovation and its strength

- integration of electronic showers, faucets and urinals from the CONTI+ range
- one controller for up to 150 faucets
- linear, star or tree layout
- intuitive and simple user interface
- data transferred via LAN, WLAN
- lifecycle data storage
- ensuring highest hygiene requirements
- reports in PDF format, saved to SD card
- protected against short circuit and reverse polarity
- no loss of data in the event of a power cut
- easy integration and installation tailored to individual requirements; user friendly to service
- compliance with the highest safety standards

CNX Water Management System applications

Buildings with high functionality and hygiene levels

Technology meets Design

Public. Commercial. Hotels

Innovative technology, superior materials and elegant design make CONTI+ products the appliances of choice in both commercial and public sanitation areas. The range includes a wide selection of sanitation products such as faucets, shower units, washbasins, urinals/WCs, Kneipp equipment, accessories, thermostatic mixer faucets. They provide every-thing you would expect to find in a contemporary restroom: ecologically sound water saving products, touch-free functions and the highest levels of hygiene. CONTI+ has ideal solutions for both security and protection against vandalism too. Unique service concepts make electronic faucets as reliable to use as mechanical single lever faucets. The programmable sanitary flushing and thermal disinfection via CNX water management system of individual fittings safeguard hygiene and potable water quality.



Hospitals and hygiene

The sanitary fittings in hygienically sensitive washing areas like hospitals, care homes, doctors' offices and food production companies are subject to particularly stringent requirements: cleanliness of washing areas, easy cleaning, regular hygienic rinse and thermal disinfection. Touch-free operation is particularly beneficial in these applications because it helps to prevent the transmission of germs and bacteria.

CONTI+ faucets and shower fittings offer excellent hygiene performance and comply with drinking water regulations. The electronically controlled operation of the fittings makes them particularly economical because no water is wasted.



The anti-scalding feature along with the thermic protection make them safe to use. The fittings are hygienically safe thanks to their individually adjustable hygienic rinse function at 12, 24, 48, or 72-hour intervals and the option of thermal disinfection.

The adaptive multifunction CONGENIAL forms the basis for numerous CONTI+ showers. Their upgrade options are therefore unique: a large number of options for extending and changing the showers and service functions are thus available. The modular design, as well as extensive functionality are the



key features of CONTI+ showers. Permanent cost saving and comfort define the choice of CONTI+ shower systems in public and semipublic areas. The adaptive multi-function CONGENIAL is the ideal basis of the CONTI+ shower systems and allows versatile modifications and upgrades: from the simple mechanical functions up to electronically operated shower systems. The quick and easy integration of CNX Water Management System into CONTI+ products brings additional control and compliance with the highest safety standards.

Shower solutions

Concealed shower faucets



Electronic timed flow shower with thermostat

- DN15 or DN20
- round and rectangular cover plate
- electronic START/STOP function
- with/without thermostatic mixer incl. anti-scalding protection
- with/without thermal disinfection
- CNX water management system compatible



Mechanical timed flow shower with thermostat

- DN15 or DN20
- round and rectangular cover plate
- electronic START/STOP function
- with/without thermostatic mixer incl. anti-scalding protection
- with/without thermal disinfection
- CNX water management system compatible



Electronic timed flow shower

- DN15 or DN20
- round and rectangular cover plate
- electronic START/STOP function
- without thermostatic mixer
- with thermal disinfection

Shower panels



Shower panel in stainless steel & AWW

- electronic or mechanical
- with/without integral tray
- DN15
- thermostatic mixer incl. anti-scalding protection
- with/without thermal disinfection
- CNX water management system compatible

Freestanding showers



Freestanding shower in stainless steel

- straight or curved shape
- DN15
- electronic START/STOP function
- thermostatic mixer incl. anti-scalding protection
- CNX water management system compatible

Exposed shower faucets



Exposed electronic shower faucets

- electronic START/STOP function
- outlet should point up or downwards
- hygienic rinse

Shower heads



Rain shower heads

- compatible with shower panels and concealed showers
- adjustable flow angle 11° to 21°
- easy to clean with a removable shower base
- chromed

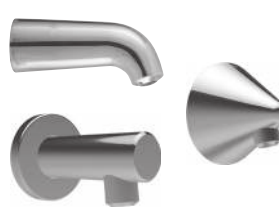

Jet shower heads

- compatible with shower panels and concealed showers
- different spray types and spray angles
- theft-proof fixings
- chromed

Hand shower kit



Hand shower kit

- compatible with shower panels and concealed showers
- single handed
- height adjustment without twisting
- stainless steel matte / chromed

Washroom solutions

Electronic washbasin faucets



Senso washbasin faucet

- with IR-sensor, with electronic mixing
- electronically touch-function
- motion and temperature indication through incorporated LED's
- illumination of the water jet (white)



Lino/Tipolino washbasin faucets

- touch-free, electronically controlled or with electronic START/STOP function
- with/without mixing, pressureless
- battery, mains operation, solar, VARIOconnect
- CNX water management system compatible
- chromed



Ultra washbasin faucets

- touch-free, electronically controlled
- 3 sizes, with/without mixing
- including preliminary shut-off
- battery, mains operation, solar, turbine, VARIOconnect
- CNX water management system compatible
- chromed



Loopino washbasin faucets

- touch-free, electronically controlled
- with/without mixing, pressureless
- battery, mains operation, VARIOconnect
- CNX water management system compatible
- chromed



IQ washbasin faucets

- touch-free, electronically controlled
- with/without mixing, pressure less
- battery, mains operation, VARIOconnect
- 12, 24, 48-hour hygienic rinse
- CNX water management system compatible
- chromed



Maxx washbasin faucets

- touch-free, electronically controlled
- with/without mixing, pressure less
- battery, mains operation, VARIOconnect
- 12, 24, 48-hour hygienic rinse
- CNX water management system compatible
- chromed



Umaxx washbasin faucets

- touch-free, electronically controlled
- without mixing (cold or pre-mixed water)
- small external reliable solenoid valve
- battery, mains operation, VARIOconnect
- 12, 24, 48-hour hygienic rinse
- chromed



H10 kitchen faucet

- hybrid kitchen faucet
- hygienic rinse adjustable
- spout 360 ° swiveling
- sensor faucet with single lever mixer
- battery, mains operation, VARIOconnect
- CNX water management system compatible
- chromed

Self-closing faucets



Tipolino self-closing faucets

- electronic START/STOP function
- with/without temperature-mixing
- battery, mains-operation, VARIOconnect
- continuous water flow time adjustable
- 12, 24, 48-hour hygienic rinse



Ultra wall-mounted faucets

- touch-free, electronically controlled
- without temperature-mixing
- integrated shut-off valve (TwistStop)
- battery, solar, VARIOconnect
- energy saving function (solar)
- chromed



Lino wall-mounted faucets

- touch-free, electronically controlled
- with/without temperature-mixing
- temporary-off and continuous water flow
- hygienic rinse adjustable
- adjustable scald protection
- battery, VARIOconnect
- chromed



Lino exposed wall-mounted faucets

- touch-free, electronically controlled or with electronic START/STOP function
- with anti-scalding and thermic protection
- temporary-off and continuous water flow
- hygienic rinse adjustable
- chromed

Electronic wall-mounted faucets

Urinals/toilets and sanitary equipment

Urinal flush valve



- Concealed urinal flush valve**
- touch-free, electronically controlled
 - double infrared sensors
 - reliable solenoid valve
 - battery, mains operation, VARIOconnect
 - CNX water management system compatible
 - stainless steel / glass black/white
 - frame chrome plated



- Concealed urinal flush valve (solar)**
- touch-free, electronically controlled
 - reliable solenoid valve
 - dynamic sensor: constantly adjusts the optimum of range
 - battery, solar, mains operation, VARIOconnect
 - CNX water management system compatible
 - chromed, window white



- Exposed urinal flush valve**
- touch-free, electronically controlled
 - short-time out
 - hygienic rinse and pre-rinse activatable
 - battery, solar
 - chromed



- Urinal siphon regulator**
- touch-free, electronically controlled
 - mounted behind the urinal
 - stadium operations
 - flush volume 1 - 4 l/min or 2 - 8 l/min
 - overflow protection
 - mains operation

Toilets / Urinal



- SteelTec Malm seatless toilet**
- profiled foot surface
 - connection from behind
 - for common toilet wall mounted flush valves DN20 and cisterns
 - stainless-steel



- Wall-mounted toilet**
- seat color selectable
 - for common toilet wall mounted flush valves and cisterns
 - stainless-steel



- Urinal**
- vandal-proof version
 - wall mounting or rear panel mounting
 - with mesh drain
 - with spray nozzle
 - shiny stainless-steel inside, outside matt



- Partition for wall mounting**
- with concealed wall bracket
 - accessory for SteelTec Oslo urinals
 - dimensions: 80 x 383 x 1092 mm
 - stainless-steel

SteelTec accessoires



- Accessoires**
- toilet brush
 - bath grip
 - soap-dispenser
 - towel dispenser
 - hygienic bin
 - paper waste bin and many more...



- Hand dryer electronic**
- wall-mounted
 - with locking and vandal-proof
 - adjustable activation distance
 - with induction motor
 - stainless steel matt



- Soap-dispenser electronic**
- for liquid soap, foam soap and disinfectant
 - wall-mounted
 - with locking and vandal-proof
 - battery, mains operation
 - dosing regulation
 - stainless steel matt



- Design series BJÖRK**
- touch-free, electronically controlled soap-dispenser
 - touch-free, electronically controlled hand dryer
 - baby diaper-changing table (load capacity up to 150 kg)
 - available in black/matt, white and all RAL colors

Wellness solutions

Wellness & Spa



- Kneipp equipments**
- Kneipp gush
 - flash affusions
 - concealed fittings
 - chromed



- Downpour/bucket shower**
- for wall or ceiling mounting
 - for indoor and outdoor use
 - wood bucket made of Iroko



- Rain shower heads**
- square and round rain shower
 - wall and ceiling mounting
 - shower pipes and shower arms can be combined
 - chromed



- Spiked and jet shower heads**
- DN15 and DN20
 - wall and ceiling mounting
 - shower pipes and shower arms can be combined
 - chromed

StoneTec / StoneTec-PRO washbasins



- Single and double washbasins**
- fixed measure
 - angular, semi-circular, round, oval basins
 - resin-bonded mineral casting/mineral material
 - white glossy / white matt



- Customized washbasins**
- customized
 - single, double and row washbasins
 - angular, semi-circular, round, oval basins
 - resin-bonded mineral casting/mineral material
 - white glossy / white matt



- Niche washbasins**
- customized varying lengths
 - single, double and row washbasins
 - angular, semi-circular, round, oval basins
 - resin-bonded mineral casting/mineral material
 - white glossy / white matt



- Barrier-free washbasins**
- for barrier-free range according to DIN 18040-1 und 18040-2
 - available in variable widths
 - resin-bonded mineral casting/mineral material
 - white glossy / white matt

SteelTec washbasins



- Wash trough design washbasins**
- for wall mounting
 - with/without hygiene edge
 - with/without drain valve
 - with/without faucet holes
 - with/without overflow
 - stainless steel matt



- Washbasins**
- stainless-steel
 - with overflow
 - with covered grid strainer
 - washboard stamping at front side
 - integral hygiene edge
 - with wall brackets



- Bucket and laboratory sink**
- for wall mounting
 - with wall panel
 - with/without plug
 - with/without bucket grid
 - stainless steel matt



- Drinking fountain**
- stainless-steel
 - for wall mounting
 - drinking fountain-faucet included
 - adjustable flow rate
 - push button, self-closing
 - vandal-proof version

Reliable & innovative

For over 40 years, the CONTI+ brand has been a byword for flexible and holistic shower room and washroom solutions for public, semi-public and commercial environments as well as the health sector.

Known for its innovative technology and high grade materials, the brand has gained a reputation for unfailing quality. With a wide-ranging product portfolio and many years of experience creating custom designs, CONTI+ is now widely recognised among design engineers and architects for its valuable contribution to their projects. Every last detail is contemplated when developing tailor-made products, resulting in smart, individual solutions to suit a plethora of applications and equipment. The choice of shower and washbasin fittings encompasses a variety of colours and finishes as well as options for surface or flush mounting. Naturally, sustainable, hygienic and reliable are prime considerations in the development of all products.

Thanks to its dependable quality and innovative technology, CONTI+ has remained a trusted brand throughout the world for over 40 years.

CONTI Sanitärarmaturen GmbH
 c/o Aquis Systems AG
 Balgacherstrasse 17
 9445 Rebstein | Switzerland
 Phone +41 71 775 9500
 Fax +41 71 777 1641
 info@conti.plus
 www.conti.plus

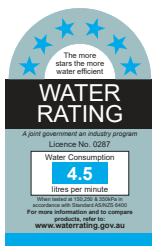

Certificates are product related and not valid in general

